



**14 Monarch Road**  
Kingsthorpe Hollow, Northampton

oriordanbond



## 14 Monarch Road

Kingsthorpe Hollow  
Northampton NN2 6EH

GUIDE PRICE £210,000

A nicely presented terraced property, situated within the sought after Kingsthorpe Hollow location, close to local amenities and the train station.

Offered with no onward chain, the accommodation comprises entrance hall, generous sitting/dining room leading to the kitchen and shower room. The first floor offers three well proportioned double bedrooms. Outside to the rear is a private, mainly laid to lawn rear garden. Further benefits include double glazing and gas radiator heating. (B/652/M)

### Additional information

- Council Tax Band: A
- Energy Efficiency Rating: D

### Viewing

Viewing strictly by appointment – details below

### Disclaimer

O’Riordan Bond Estate Agents Limited has not tested apparatus, equipment, fittings or services and so cannot verify they are in working order. The buyer is advised to obtain verification from their solicitor or surveyor.

O’Riordan Bond Kingsthorpe Sales  
01604 722007  
kingsthorpe@oriordanbond.co.uk



GROUND FLOOR  
323 sq.ft. (30.0 sq.m.) approx.

1ST FLOOR  
329 sq.ft. (30.5 sq.m.) approx.

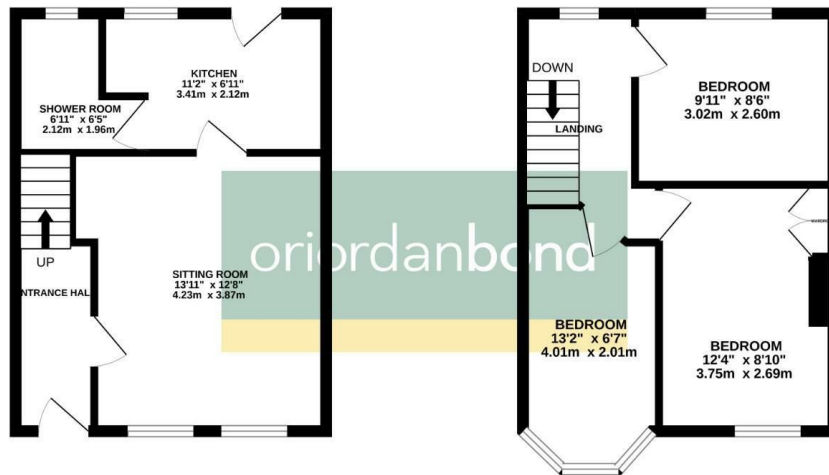

TOTAL FLOOR AREA: 652 sq.ft. (60.5 sq.m.) approx.

While every attempt has been made to ensure the accuracy of the floorplan contained here, measurements of doors, windows, rooms and any other items are approximate and no responsibility is taken for any error, omission or mis-statement. This plan is for illustrative purposes only and should be used as such by any prospective purchaser. The services, systems and appliances shown have not been tested and no guarantee as to their operability or efficiency can be given.  
Made with Metropix 02022